

A Project By:



Site: 1 KM FROM NEW PAL GAURAVPATH 6 ROAD JUNCTION,  
2 KM FROM UGAT CANAL ( D MART ), DANDI ROAD, VANAKLA, SURAT.

Ph.: +91 88667 52222  
Email: Silverstonevillas@gmail.com

DISCLAIMER • IMAGES SHOWN IN THE BROCHURE ARE JUST FOR VIEWING & REFERENCE PURPOSE. ONLY. IT DOES NOT STATE OR DEMAND ANY MEASUREMENTS. THIS IS THE PROJECT OF OPEN PLOTS ONLY. DEVELOPER DOES NOT HOLD ANY RESPONSIBILITY OR LIABILITY FOR ROWHOUSES AND ITS CONSTRUCTION. DETAILS MENTIONED IN THE BROCHURE MAY CHANGE AS PER REQUIREMENT AND MAY VARY. THIS BROCHURE IS PRINTED OR CREATED JUST TO GIVE SOME BASIC / TENTATIVE IDEA OF DESIGN AND DETAILS. AND MAY NOT BE THE EXACT SAME

RERA No: PR/GJ/SURAT/CHORASI/SUDA/PAA09842/250222 | RERA website: gujrera.gujarat.gov.in



*Splendid & Peaceful Homes*

**OPEN PLOTS FOR  
BUNGALOWS & ROWHOUSE**





*When your busy schedules begin to tire you, when a rejuvenating break becomes a necessity - Silverstone Villas is your grand escape to a world of serenity. Set in the lap of mother nature, just 2 km from the Ugat Canal, Silverstone Villas offer you infrastructure ready plots that will delight you with its soothing sights and smells, sounds and experiences*

*Your search for peace and tranquility will end at this premium plotting villa scheme that endeavours to fill your lives with joy. A perfect weekend nature retreat where large plot sizes, landscaped campus and premium lifestyle amenities await you in a vibrant gated community. A holiday home that refreshes you today and ensures capital appreciation in the long run.*

Welcome to a **world where greens rule**



Welcome to a **world where luxury lives**

Welcome to a **world where life pauses**







*The large plot sizes at Silverstone Villas offer you the spacious villa layouts that can house 4 bedrooms, perfect to accommodate your family and friends. The plan includes plenty of open spaces like verandas, balconies, terrace garden and patio within each villa to bring the outdoors in.*

*At Silverstone Villas, you will enjoy nature's bounty along with the comfort of a modern lifestyle. The sprawling campus is peppered with wide driveways, landscaped elements, common plots and leisure amenities to impart a luxurious feel.*

**Step into a life of exciting recreation**



**Step into a life of calming relaxation**

**Step into a life of eternal bliss**









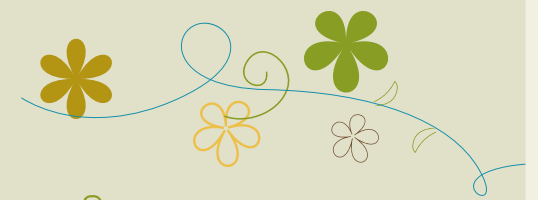













**Recreational Facilities Include:**



-  **Multipurpose Hall**
-  **Banquet Hall**
-  **Theatre**
-  **Gazebo**
-  **Yoga and Meditation**
-  **Volleyball / Badminton Court**
-  **Senior Citizen Sitting**
-  **Landscape Gardens**
-  **Children Play Area**
-  **Skating Ring**
-  **Solar Powered Campus**
-  **CCTV Camera Campus**
-  **Security Cabin with Surveillance Room**
-  **CC Road with Pavour Block In Crossing**
-  **Solar Street Light**
-  **Drainage and Water Supply**





# Layout Plan



## LEGENDS

- 01 FOYER
- 02 STAGE
- 03 BANQUET HALL/  
MULTIPURPOSE HALL
- 04 KITCHEN
- 05 KITCHEN STORE
- 06 TOILET
- 07 BATHROOM
- 08 GARDEN
- 09 GARDEN
- 10 GAZEBO
- 11 SKATING RING
- 12 SANDPIT
- 13 BADMINTON COURT
- 14 SECURITY CABIN



Splendid & Peaceful Homes



*Unit Plan*

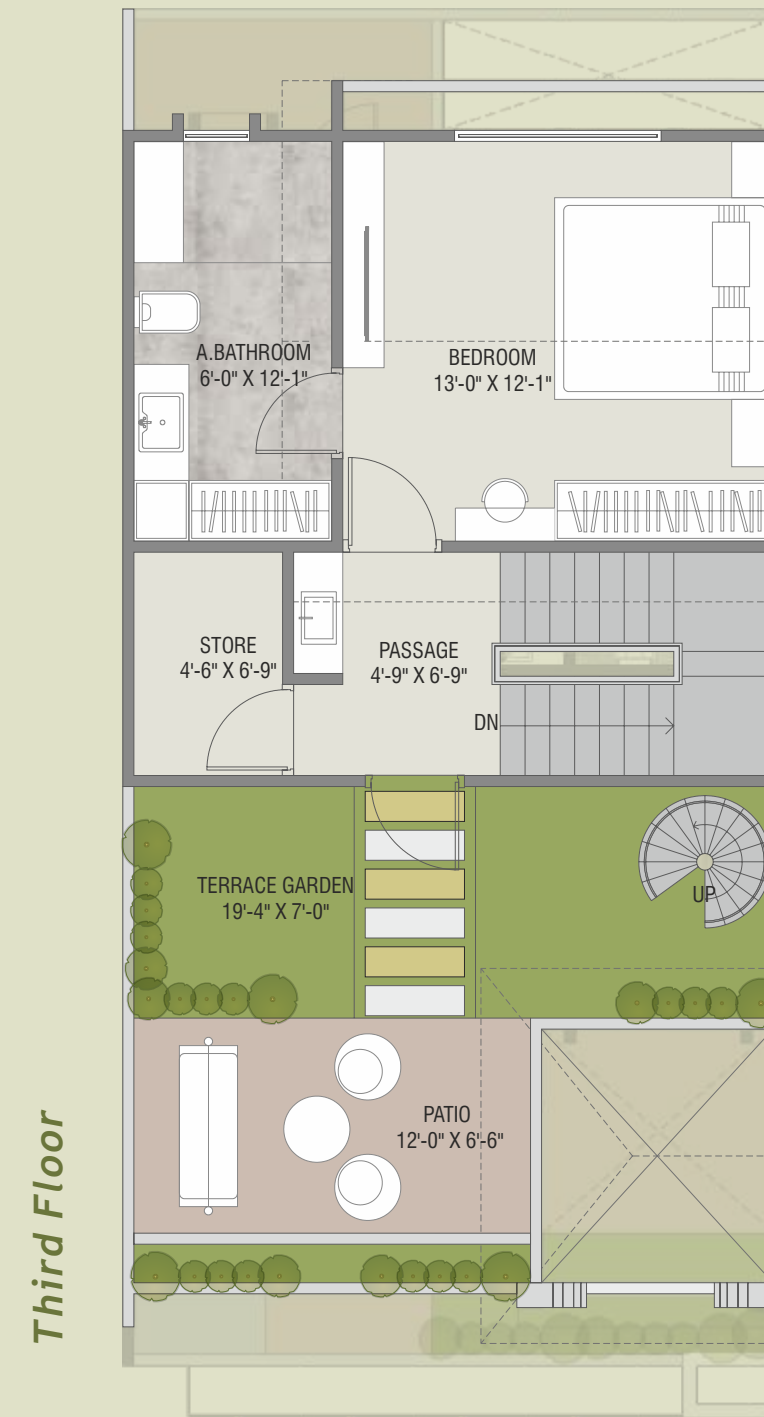
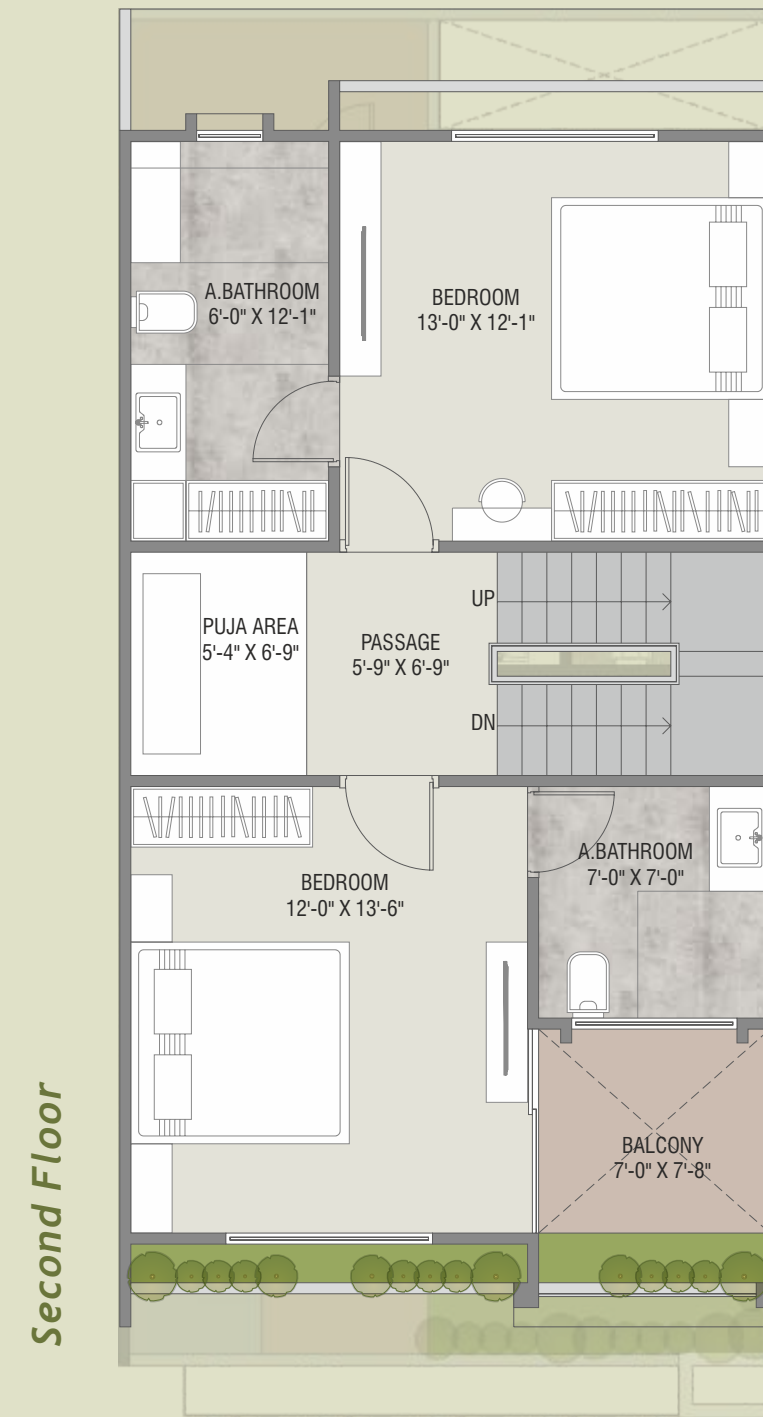
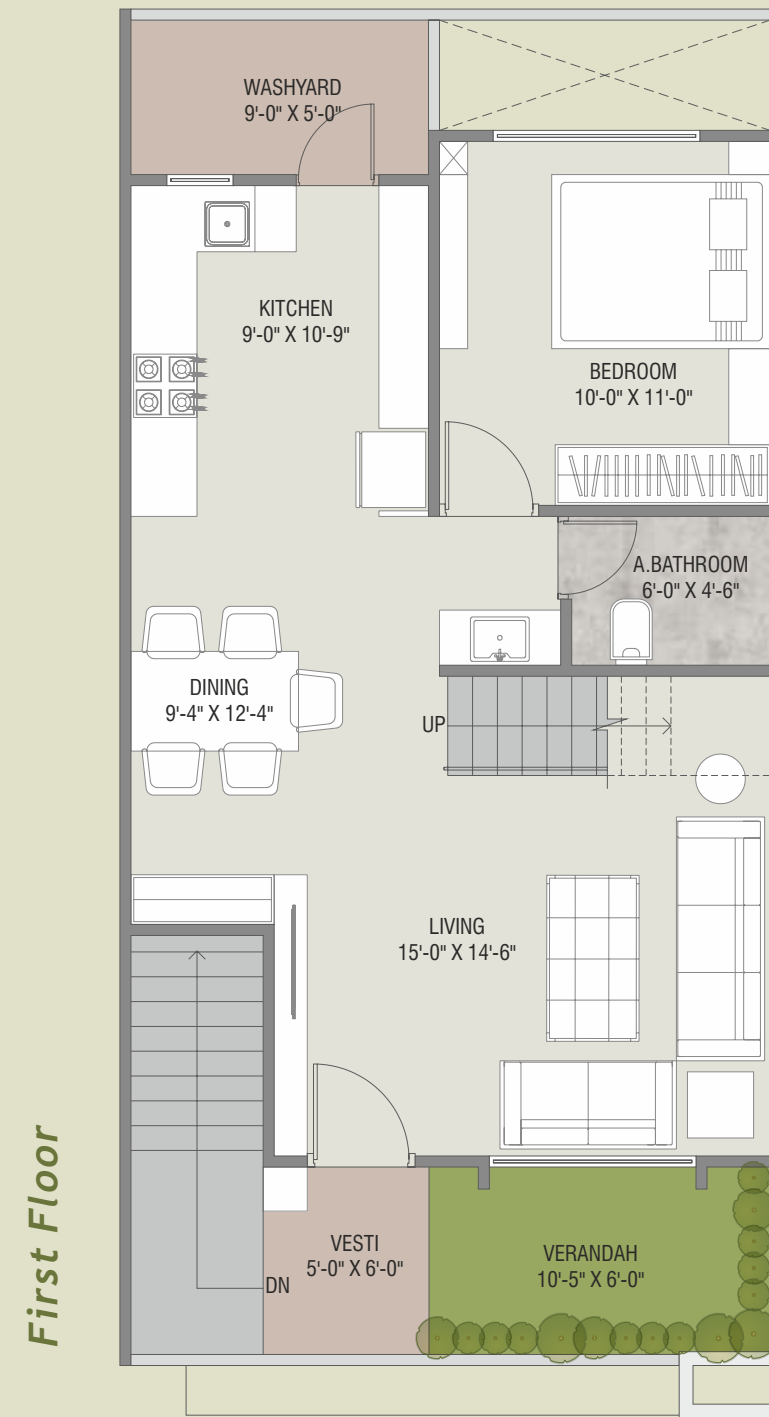
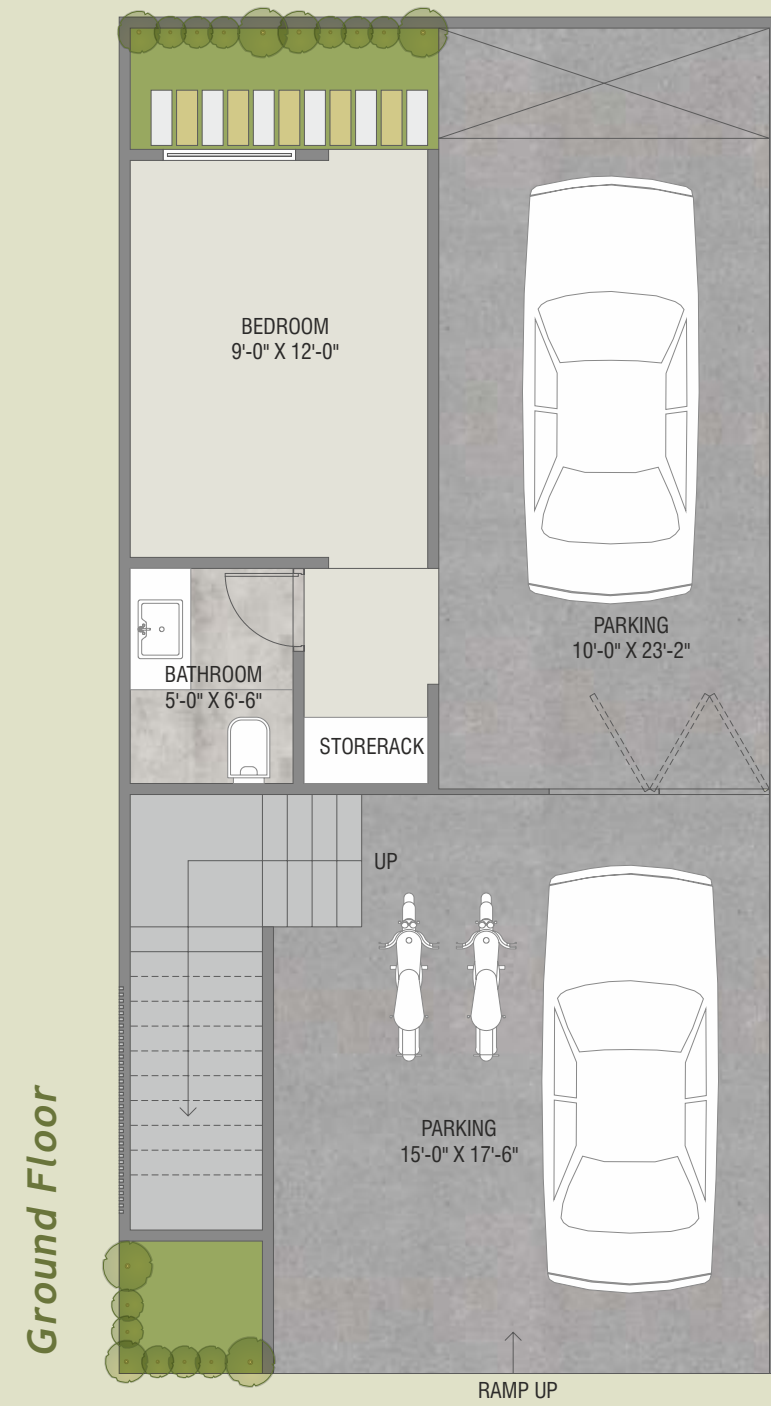

Plan for Reference Only





Splendid & Peaceful Homes