

## WHAT WE ARE

Sartha Infrastructure has been established as a real estate developer, located in Surat. The Company is led by promoters who have experience of 34 years of creating visionary products, they have a post record of completing residential & commercial buildings, conducting government projects & infrastructure development.

The company firmly believes in offering innovative products combined with an emphasis on contemporary architecture, strong project execution and quality construction. The group owner has a versatile portfolio of premium and essential housing, farmhouse and bungalows, recreational space and office towers.

### COMPANY MISSION

To create path breaking visionary spaces, which deliver a superb experience with enhanced lifestyle to the clients. Done with utmost loyalty, commitment & hard work.





**ALTARIUS**  
2 BHK RESIDENTIAL & COMMERCIAL SPACE

 a residential project set amidst  
great **nature beauty**



Built with the modern elevation, the project  
made is, absolutely in harmony with nature and  
mankind without disrupting one another.













# LIFESTYLE AMENITIES



- Ac. Gym
- Indoor kids play area
- Outdoor Seating
- Table Tennis
- Multi camera security CCTV in Common area
- 24 x 7 Security Service allowance
- Yoga room
- Lush Green Garden
- Lift of standard co. like kone or equiv
- Driver Seating space
- Impressive Elevation of building
- Designer Entrance gate of campus
- Designer Street light
- Decorated Entrance reception
- Artistic name board in each building lobby



The most happening place at Altarius  
Enjoy the togetherness in a beautiful environment made just for you





# ALTARIUS

2 BHK RESIDENTIAL & COMMERCIAL SPACE







BUSINESS

Finally your answer to a place where Business happens...  
Your presence, your address matters the most...



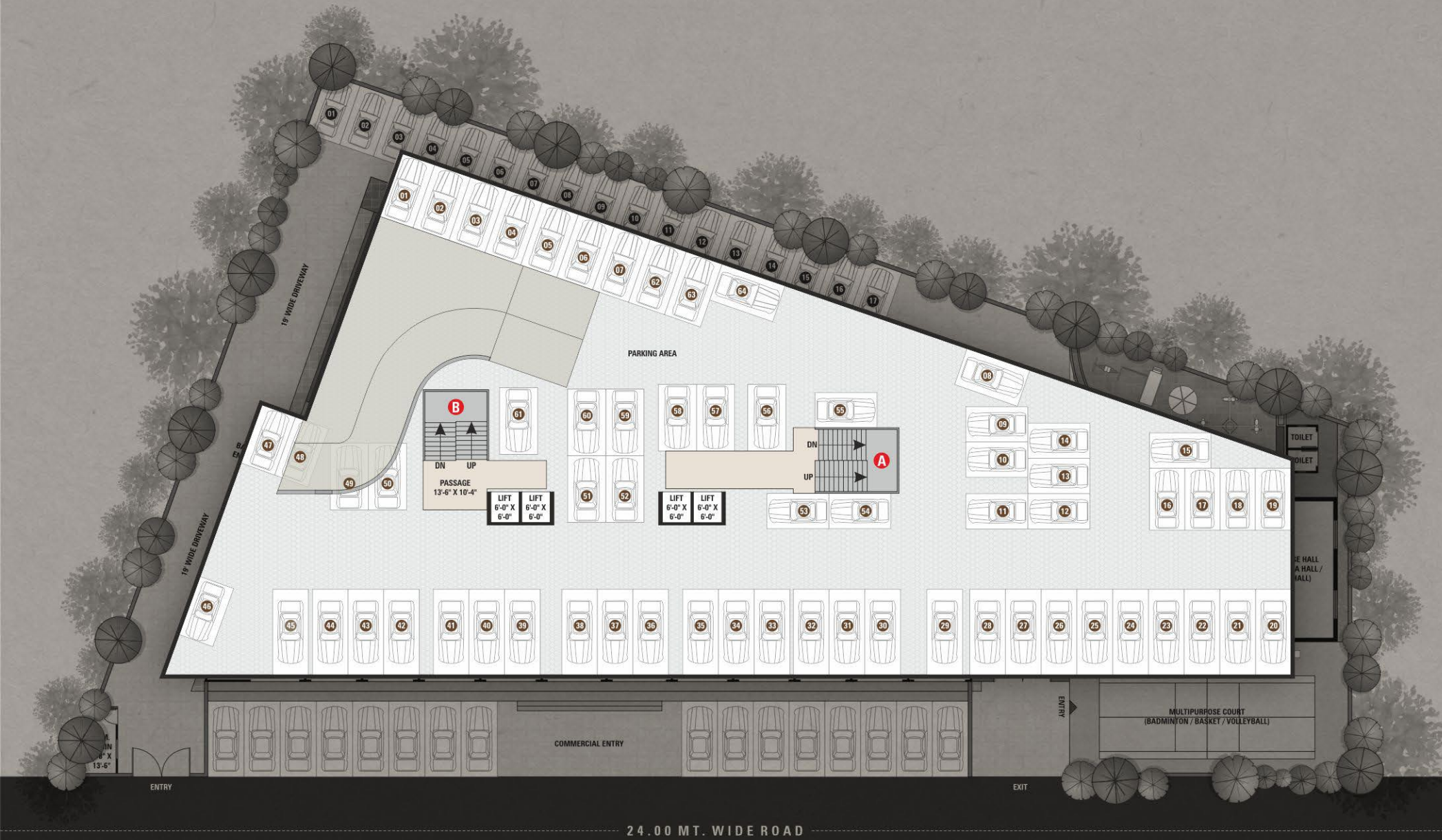

**BASEMENT PLAN**  
PARKING



**GROUND FLOOR PLAN**  
COMMERCIAL SPACE





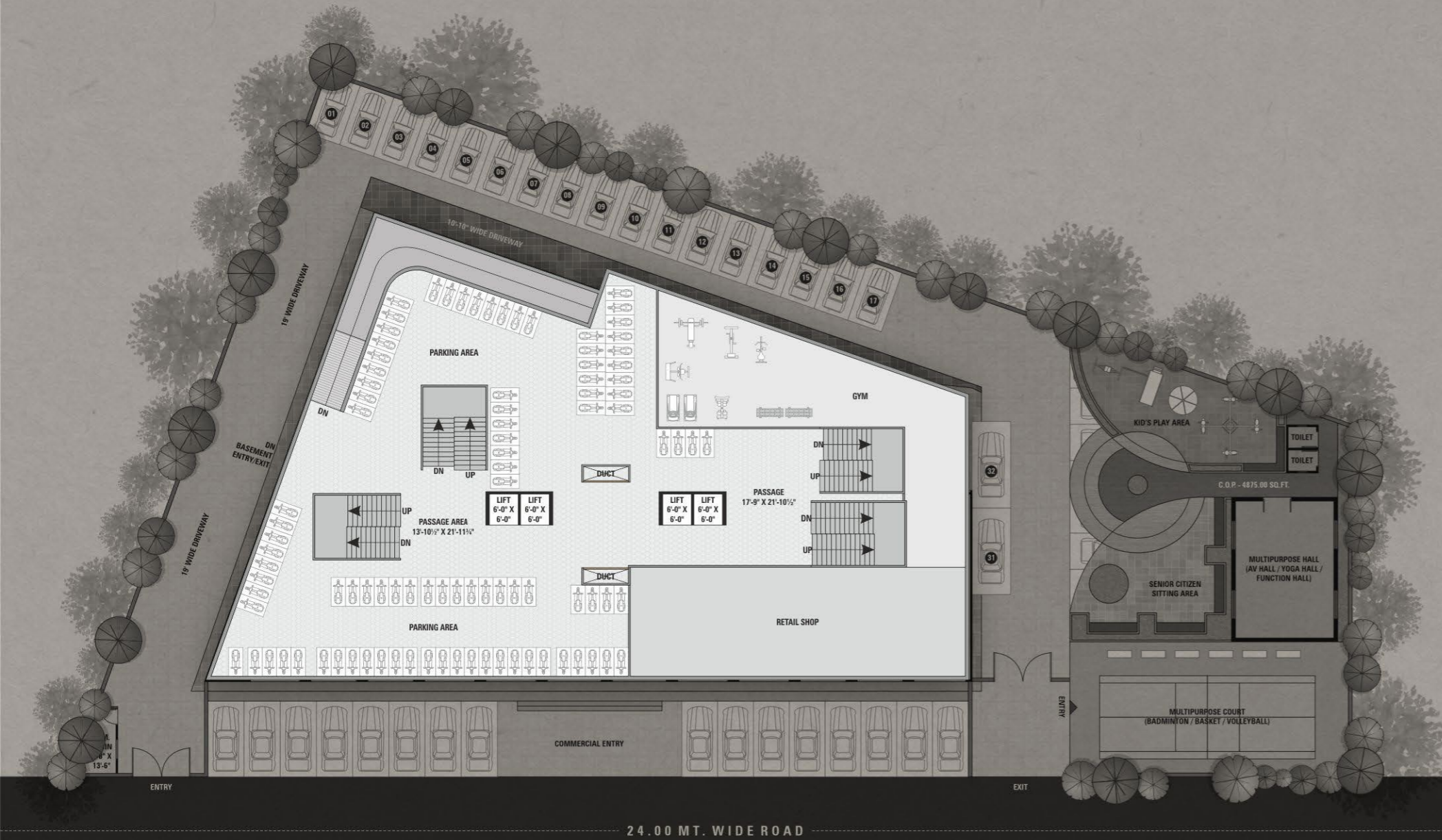

FIRST FLOOR PLAN  
PARKING



TYPICAL FLOOR PLAN  
2ND TO 13TH FLOOR





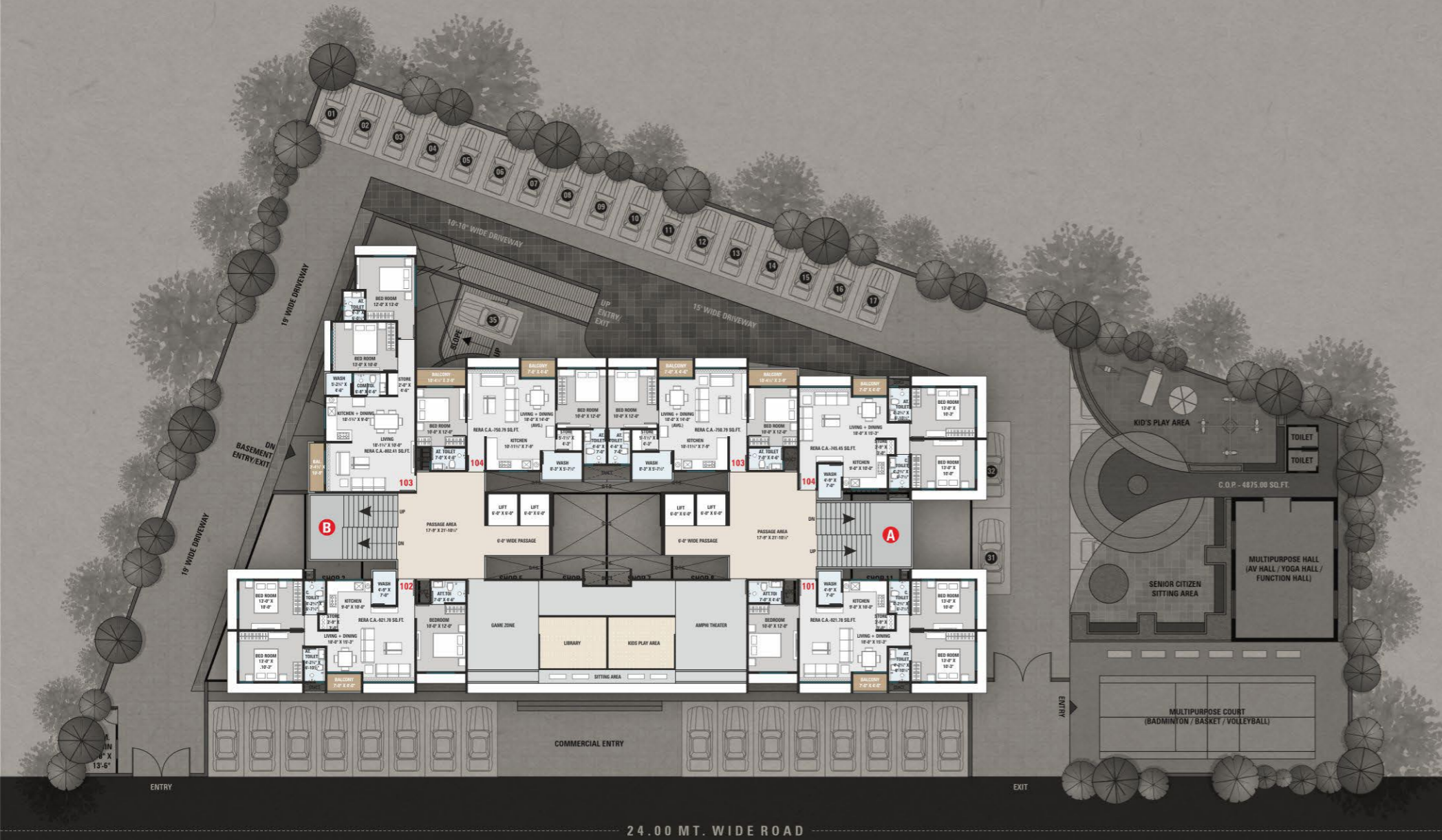

**FLOOR PLAN**  
14TH FLOOR



**TERRACE PLAN**

